

Foundation earther: Better safe than sorry

Protective Cap for Terminal Lugs - ProtectionBall

At the moment the ProtectionBall is the only cap, which meets the requirements of DIN 18014 in real life at the construction site! Due to the reflecting sheet the ProtectionBall is always visible at the construction site at dusk and in low light, e.g. in the basement area.

**Striking, reflective
marking**

**To prevent accidents
during the construction
phase**

**Required in accordance
with DIN 18014**

**For mounting on round
and flat conductor**



ProtectionBall



Protective cap for connection lugs, reflective



Type	Fit mm	Pack. pcs	Weight kg/100 pcs.	Item No.
ProtectionBall	RD 8-10/ FL 25/ 30/ 40	25	2,050	5018 01 4
PE Polyethylene				/100 pcs

- For snapping onto round conductors or flat conductors
- Noticeable, reflective label
- For accident protection during the construction phase

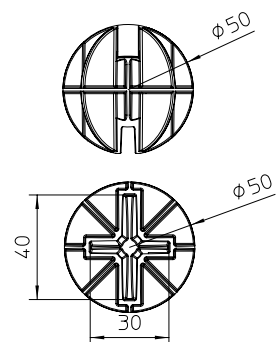

OBO BETTERMANN GmbH & Co. KG
PO Box 1120 · D-58694 Menden

Customer Service Germany
Tel.: +49 (0) 23 73/89-15 00
Fax: +49 (0) 23 73/89-12 38

www.obo-bettermann.com

OBO
BETTERMANN